



Fabryka Elementów Napędowych "FENA" sp. z o.o.

40-663 Katowice, ul. Kasztanowa 8; tel./fax +48 32 245 61 65, 245 17 55

www.fena.pl

TECHNICAL INFORMATION: tel. +48 32 245 17 15, 245 15 22, e-mail: fena@fena.pl

## SPJ (E series) SINGLE-SIDED TOOTH COUPLINGS

Example of designation: of the SPJ type coupling with the nominal torque of  $M_n=22000$  Nm, hub holes diameters of  $d_1=60$  mm,  $d_2=80$ mm, hub holes lengths  $l_1=105$  mm,  $l_2=101$  mm, size of 130:

cat. page no.

SPJ/E

10.2014

22000-60/105-80/101-130 SPJ single-sided tooth coupling

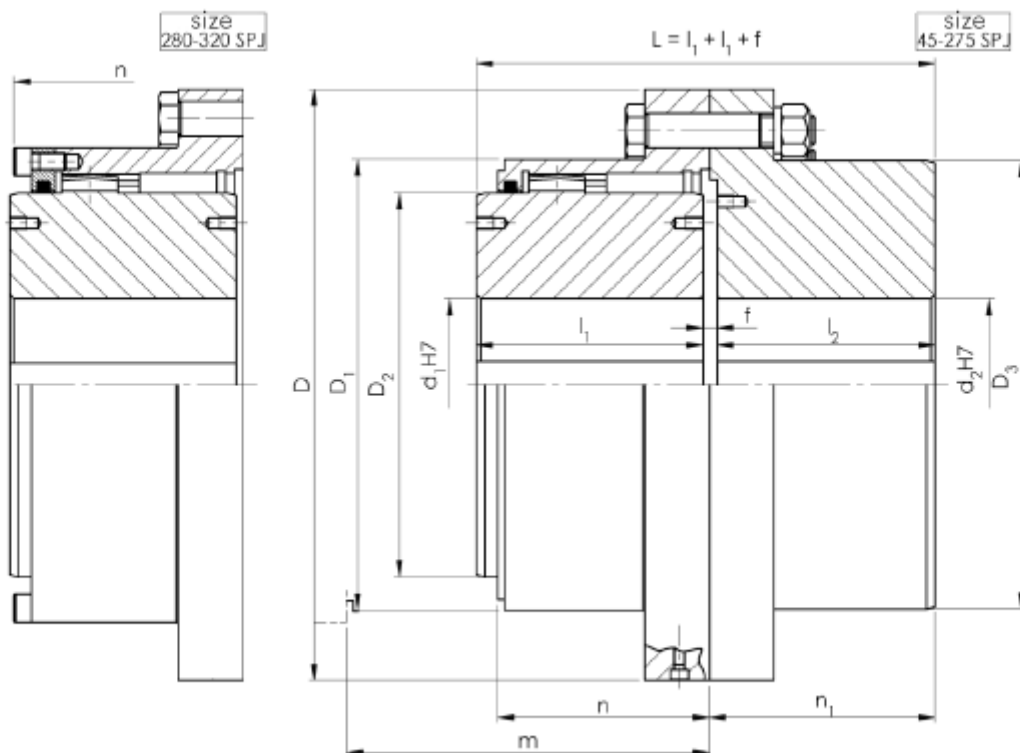

Nominal torque $M_n$	$d_1, d_2$	$l_1$		$l_2$	f	D	$D_1$	$D_2$	$D_3$	n	$n_1$	$m^{1)}$		Max rotational speed <sup>2)</sup> $n_{max}$	Moment of inertia <sup>3)</sup> I	Weight <sup>4)</sup> m	SPJ coupling size			
		max	nom.									extended	nom.					nom.	extended	
Nm		mm															1/min	kgm <sup>2</sup>	kg	
1300	45	43	80	40	5	111	80	67	80	41	43,5	73,5	81,5	5000	0,005	4,1	45			
2800	60	50	114	47	5	141	103,5	87	103,5	47	50,5	83	115,5	4400	0,016	8,2	60			
5000	75	62	130	58	5	171	129,5	106	126	58,5	61,5	106	131,5	4000	0,04	14,6	75			
10000	95	76	146	74	6	210	156	130	152	68,5	77,5	124,5		3600	0,107	26,5	95			
16000	110	90	165	87	6	234	181	151	178	82	90,5	147,5	167,5	3350	0,197	39,6	110			
22000	130	105	170	101	6,5	274	209	178	208	98	104,5	175	175	3100	0,446	60,3	130			
32000	155	120	190	113	6,5	312	247	213	245	108,5	116,5	196	196	2800	0,868	90,3	155			
45000	175	135	200	129	8	337	273	235	270	121	133	220	220	2700	1,362	119	175			
62000	195	150	220	150	8	380	307	263	305	132	154	242	242	2550	2,584	174,3	195			
84000	215	175	250	175	8	405	338	286	330	151,5	179	281	281	2450	3,9	231,1	215			
115000	240	190	280	190	10	444	368	316	362	165	196	308	308	2300	5,65	285,2	240			
174000	275	220	350	220	13	506	426	372	416	183,5	228	344	355	2150	11,446	429,3	275			
488000	280	280	410	280	13	591	472	394	-	225	288	316	447,5	1900	22,6	648	280			
580000	320	292	470	292	14,5	640	518	432	-	234	300	330	467,5	1800	34,5	822	320			

We produce splineways as recommended, normally acc. to PN-70/M-85005, with the Js9 tolerance.

Material – steel,

- <sup>1)</sup> Dimension defining pushing the basket aside in order to control the hubs position and check meshing.
- <sup>2)</sup> Higher rotational speed is possible on request.
- <sup>3)</sup> Moment of inertia was determined for couplings without holes.
- <sup>4)</sup> Weight was determined for couplings with lead holes.

Exemplary applications: pumps; fans; belt and roller conveyors; cranes and other machines and equipment. Deviations according to SP/0 sheet.

***We also offer special tailor-made versions.***