

ASRY-STH DISC COUPLINGS

with the possibility of replacement of the insert without the necessity of drawing the pins aside and with the brake disc with the possibility of its disassembly without removing the hub from the pin.

Example of designation of the ASRY-STH coupling with the nominal torque of $M_n=265\text{Nm}$, brake disc diameter of $D_H=320\text{ mm}$, thickness of $B=30\text{ mm}$, distances of symmetry axis of the brake disc $L_H=34\text{ mm}$, hub hole diameters of $d_1=32\text{mm}$, $d_2=42\text{mm}$, hub holes lengths of $l_1=50\text{mm}$, $l_2=65\text{mm}$, size of 003: (marking see page A1-1)

265-320x30-34-32/50-42/65-003 ASRY-STH Disc coupling

- the version „Ex” - 265-320x30-34-32/50-42/65-003 ASRY-STH-**Ex** Disc coupling
- the version “WD”- 265-320x30-34-32/50-42/65-003 ASRY-STH-**WD** Disc coupling
- with lead holes - 265-320x30-34-**ow**/50-**ow**/65-003 ASRY-STH Disc coupling

To replace the insert without the necessity of drawing the pins aside, they cannot inside the coupling stand out the edges of the hub.

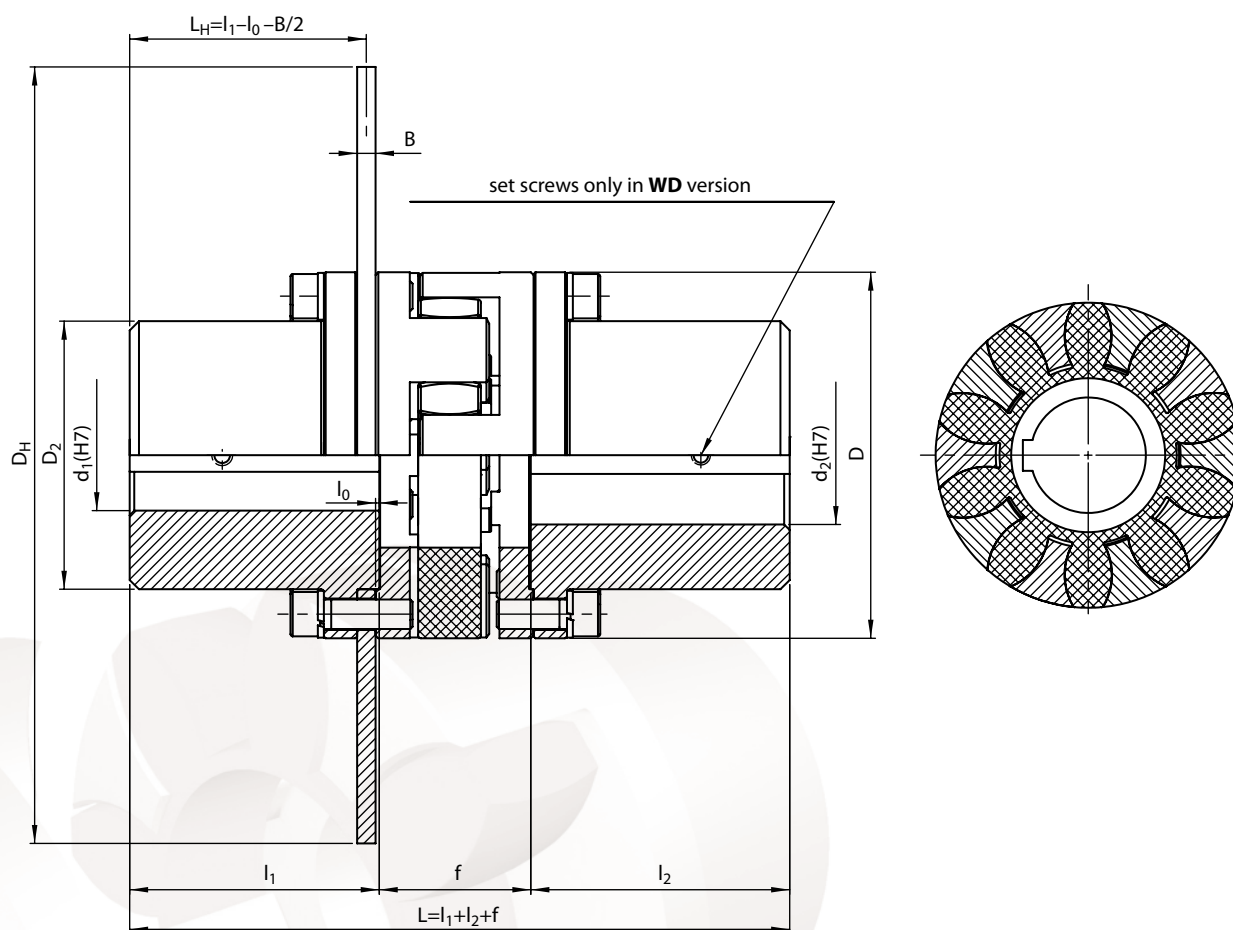

Nominal torque M_n	d_1, d_2		$l_1, l_2^{1)}$		f	D	D_2	$D_H \times B^3)$	$l_0^{4)}$	Max rotational speed ⁵⁾ n_{max}	Moment of inertia ²⁾ I	Weight ²⁾ m	Coupling size and type			
	initial	max	nomin.	extend.												
Nm	mm												1/min	kgm ²	kg	-
265	12	42	50	80	48	95	63	320x30	1	2000	0,244	21,4	003 ASRY-STH			
310	14	48	56	80	50	105	72	320x30	1	2000	0,247	22,3	004 ASRY-STH			
								355x30								
410	16	55	65	90	60	120	82	355x30	1	1800	0,377	28,8	005 ASRY-STH			
								400x30								
625	18	65	75	110	65	135	96	400x30	1	1500	0,610	37,4	006 ASRY-STH			
								450x30								

continuation of the table on the next page

continuation of the table from the previous page

Nominal torque M_n	d_1, d_2		l_1, l_2 ¹⁾		f	D	D ₂	D _H ×B ³⁾	l ₀ ⁴⁾	Max rotational speed ⁵⁾ n _{max}	Moment of inertia ²⁾ I	Weight ²⁾ m	Coupling size and type
	initial	max	nomin.	extend.									
Nm	mm								1/min	kgm ²	kg	-	
975	22	75	85	140	75	160	112	450x30	1,5	1500	0,992	50,3	007 ASRY-STH
								500x30		1500	1,485	59,1	
2400	26	100	100	140	82	200	145	500x30	1,5	1500	1,573	69,7	008 ASRY-STH
								630x30		1000	3,756	96,7	
3300	30	110	110	160	97	225	165	630x30	1,5	1000	3,869	107,1	009 ASRY-STH
								710x30		1000	6,088	126,8	
4800	30	125	120	170	103	255	180	630x30	2	1000	4,074	122,2	010 ASRY-STH
								710x30		1000	6,293	141,9	

We are also offering tailor-made special versions.

We produce splineways as recommended, normally acc. to PN-70/M-85005, with the Js9 tolerance

- 1) On request, we produce couplings with hub lengths different than the nominal and extended lengths provided in the table.
 - 2) The weight and the moment of inertia have been determined for the coupling with the maximum holes and nominal lengths of the hubs.
 - 3) On request, we produce couplings brake discs with dimensions different than those provided in the table
 - 4) l_0 ($L_H = l_1 - l_0 - B/2$) dimension after the agreement can be changed according to the wish of the customer.
 - 5) After the dynamic balance the maximum rotational speed can be increased (the dynamic balance must be agreed).
- Couplings with brake disc Ø450 and bigger are normally balanced dynamically, other couplings are balanced statically.
 - After the agreement the couplings can be made with the holes for protective discs in hubs.