

**Example of designation** of the ASOT type coupling with the nominal torque of  $M_n=250$  Nm, with the TZ outer clamping bush with the diameter of  $d_1=38$  and the TW inner clamping bush with the diameter of  $d_2=45$  mm, size of 070: (marking see page A5-1)  
**250-38TZ-45TW- 070 ASOT Tyre coupling**

size  
040-060 ASOT

size  
070-250 ASOT

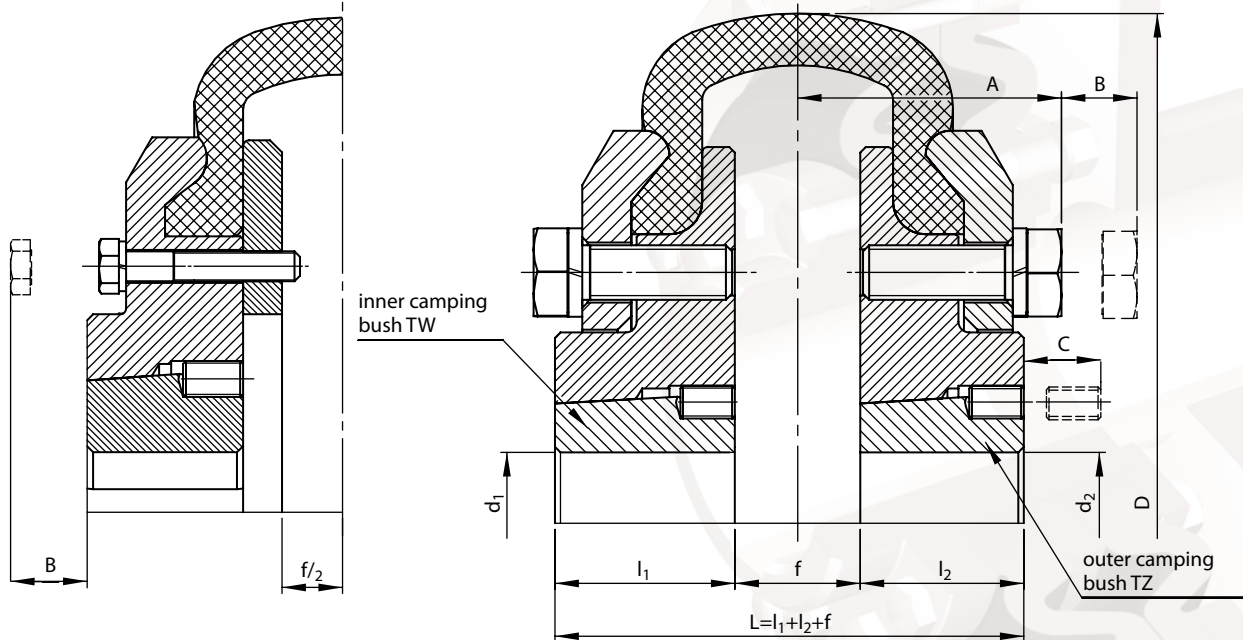

Nominal torque $M_n$ Nm	Hub with TW bush				Hub with TZ bush				f	D	A	B <sup>3)</sup>	C <sup>4)</sup>	Max rotational speed $n_{max}$ 1/min	Moment of inertia <sup>2)</sup> I kgm <sup>2</sup>	Weight <sup>2)</sup> m kg	Coupling size and type
	$d_1, d_2$ min. max.		$l_1, l_2$ <sup>1)</sup> bush		$d_1, d_2$ min. max.		$l_1, l_2$ <sup>1)</sup> bush										
	mm																
24	10	25	23	1008	10	25	23	1008	22	104	-	-	13	4500	0,0015	1,8	040 ASOT
66	14	32	26	1210	14	32	26	1210	25	133	-	-	16	4500	0,0024	2,6	050 ASOT
127	14	42	26	1610	14	42	26	1610	33	165	-	-	16	4000	0,011	4,5	060 ASOT
250	19	50	33	2012	14	42	26	1610	23	187	50	15	16	3600	0,019	7,0	070 ASOT
375	19	65	45	2517	19	50	33	2012	25	211	54	18	22	3100	0,038	11,0	080 ASOT
500	19	65	45	2517	19	65	45	2517	25	235	60	18	26	3000	0,067	15,9	090 ASOT
675	28	75	52	3020	19	65	45	2517	25	254	62	18	26	2600	0,116	22,4	100 ASOT
875	28	75	52	3020	28	75	52	3020	25	279	62	18	32	2300	0,175	29,8	110 ASOT
1330	38	80	65	3525	28	75	52	3020	29	314	67	18	32	2050	0,298	41,0	120 ASOT
2325	38	80	65	3525	38	80	65	3525	32	359	73	19	38	1800	0,557	53,8	140 ASOT
3770	40	90	76	4030	40	90	76	4030	30	402	78	21	38	1600	1,07	91,5	160 ASOT
6270	65	120	89	4535	65	120	89	4535	46	470	94	21	52	1500	1,92	122	180 ASOT
9325	65	120	89	4535	65	120	89	4535	48	508	103	21	52	1300	2,85	146	200 ASOT
11600	70	125	102	5040	70	125	102	5040	55	562	118	22	58	1100	4,78	210	220 ASOT

**We are also offering tailor-made special versions.**

We produce splineways as recommended, normally acc. to PN-70/M-85005, with the Js9 tolerance.

1) On request, we produce couplings with hub lengths different than the nominal and extended lengths provided in the table.

2) The weight and the moment of inertia have been determined for the coupling with the maximum holes and nominal lengths of the hubs.

3) The size of loosening the collet set screws to replace the tyre.

4) The length of the screws clamping the collets (given for the collets in the value appropriate for TZ construction)