

continuation of the table from the previous page

Nominal torque M_n	d_1, d_2		l_1, l_2 ¹⁾		f	D	D_2	$D_H \times B$ ³⁾	l_0 ⁴⁾	Max rotational speed ⁵⁾ n_{max}	Moment of inertia ²⁾ I	Weight ²⁾ m	Coupling size and type
	initial	max	nomin.	extend.									
Nm	mm								1/min	kgm ²	kg	-	
8300	30	140	165	210	125	360	210	800 x 40	2,5	1000	14,39	262,5	012 ASNY-STH
11400	30	150	175	210	125	400	220	800 x 40	2,5	1000	15,11	277,7	013 ASNY-STH
								1000 x 40		1000	33,19	365,9	

We are also offering tailor-made special versions.

We produce splineways as recommended, normally acc. to PN-70/M-85005, with the Js9 tolerance

- 1) On request, we produce couplings with hub lengths different than the nominal and extended lengths provided in the table.
 - 2) The weight and the moment of inertia have been determined for the coupling with the maximum holes and nominal lengths of the hubs.
 - 3) On request, we produce couplings brake discs with dimensions different than those provided in the table
 - 4) l_0 ($L_H = l_1 - l_0 - B/2$) dimension after the agreement can be changed according to the wish of the customer.
 - 5) After the dynamic balance the maximum rotational speed can be increased (the dynamic balance must be agreed).
- Couplings with brake disc Ø450 and bigger are normally balanced dynamically, other couplings are balanced statically.
 - After the agreement the couplings can be made with the holes for protective discs in hubs.

ASNG FLEXIBLE COUPLINGS

With the possibility of replacement of the insert without the necessity of drawing the pins aside

BRAKE – ASNG-SBH with brake drum

DISC – ASNG-STH with brake disc

Example of designation of the ASNG couplings with the nominal torque of $M_n=8300$ Nm, hub holes diameters of $d_1=140$ mm, $d_2=120$ mm, hub holes lengths of $l_1=250$ mm, $l_2=200$ mm, size of 022: (marking see page A2-1)

8300-140/250-120/200-022 ASNG Flexible Coupling

brake drum diameter of $D_H=710$ mm, distance of symmetry axis of brake drum jacket of $L_H=240$ mm,

8300-710-240-140/250-120/200-022 ASNG-SBH Brake coupling

brake disc diameter $D_H=710$ and thickness of $B=30$ mm, distance of symmetry axis of brake disc $L_H=231$ mm

8300-710x30-231-140/250-120/200-022 ASNG-STH Disc coupling

- the version „Ex” – 8300-140/250-120/200-022 ASNG-**Ex** Flexible coupling
8300-140/250-120/200-022 ASNG-SBH-**Ex** Brake coupling
8300-140/250-120/200-022 ASNG-STH-**Ex** Disc coupling

Nominal torque M_n	d_1	d_2	l_1, l_2 ¹⁾		f	D	D_H ³⁾	B ³⁾	l_0 ⁴⁾	Max rotational speed ⁵⁾ n_{max}	Moment of inertia ²⁾ I	Weight ²⁾ m	Coupling size and type
	max	nomin.	extend.										
Nm	mm								1/min	kgm ²	kg	-	
5000	120	110	165	210	30	300	-	-	-	2250	0,66	64	021 ASNG
							500	190	10	1500	4,34	141	021 ASNG-SBH
							630	235		1200	11,26	207	
							710	265		1000	18,11	250	
							710	30	4	1000	6,52	159	021 ASNG-STH
							800	30		1000	10,09	184	

continuation of the table on the next page

continuation of the table from the previous page

Nominal torque M_n	d_1	d_2	l_1, l_2 ¹⁾		f	D	D_H ³⁾	B ³⁾	l_0 ⁴⁾	Max rotational speed ⁵⁾ n_{max}	Moment of inertia ²⁾ I	Weight ²⁾ m	Coupling size and type
	max		nomin.	extend.									
8300	150	140	200	250	35	360	-	-	-	2000	2,0	129	022 ASNG
							630	235	10	1200	12,50	269	022 ASNG-SBH
							710	265		1000	19,43	312	
							710	30	4	1000	7,84	222	022 ASNG-STH
							800	30		1000	11,38	244	
11400	150	150	200	250	40	400	-	-	-	1600	2,46	142	023 ASNG
							710	265	10	1000	19,87	323	023 ASNG-SBH
							800	290		1000	33,72	396	
							800	30	4	1000	11,81	249	023 ASNG-STH
							1000	30		1000	25,37	315	
18000	180	160	240	280	47	480	-	-	-	1200	6,17	228	024 ASNG
							800	290	15	1000	37,28	473	024 ASNG-SBH
							1000	30	4	1000	28,15	385	024 ASNG-STH

We are also offering tailor-made special versions.

We produce splineways as recommended, normally acc. to PN-70/M-85005, with the Js9 tolerance

- 1) On request, we produce couplings with hub lengths different than the nominal and extended lengths provided in the table (hubs longer than the lengthened after the agreement)
 - 2) The weight and the moment of inertia have been determined for the coupling with the maximum holes and nominal lengths of the hubs.
 - 3) On request, we produce couplings brake drums and discs with dimensions different than those provided in the table
 - 4) l_0 (for SBH $L_H = l_1 - l_0$; for STH $L_H = l_1 - l_0 - B/2$) dimension after the agreement can be changed according to the wish of the customer.
 - 5) After the dynamic balance the maximum rotational speed can be increased (the dynamic balance must be agreed).
- Couplings with brake discs and drums are normally balanced dynamically, other couplings are balanced statically.
 - After the agreement the couplings can be made with the holes for protective discs in hubs.

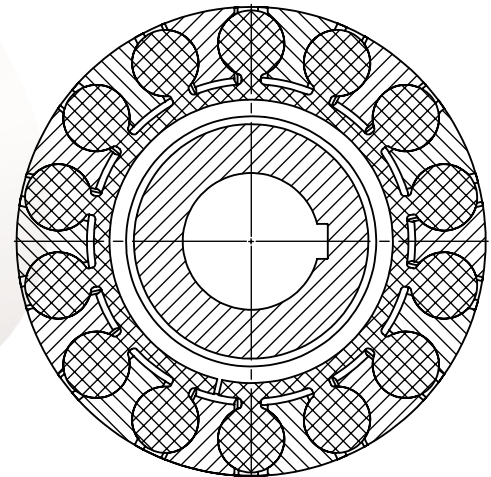
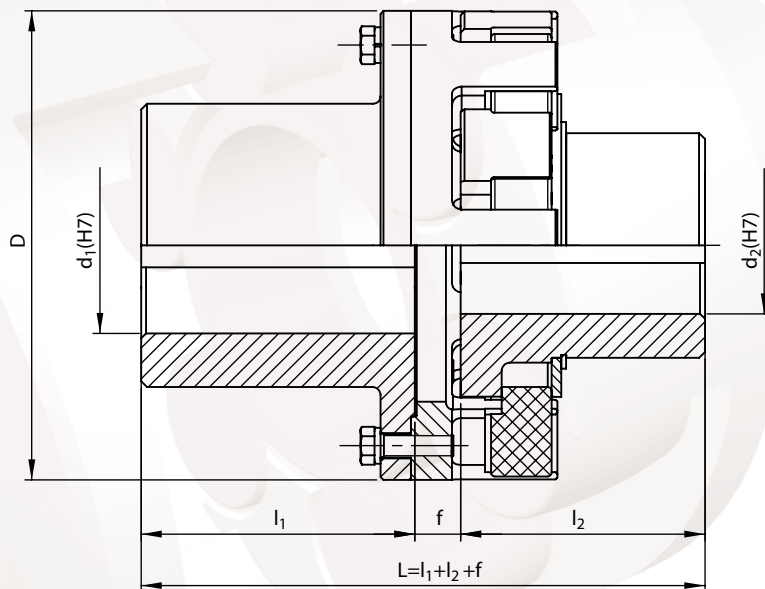

Flexible coupling ASNG

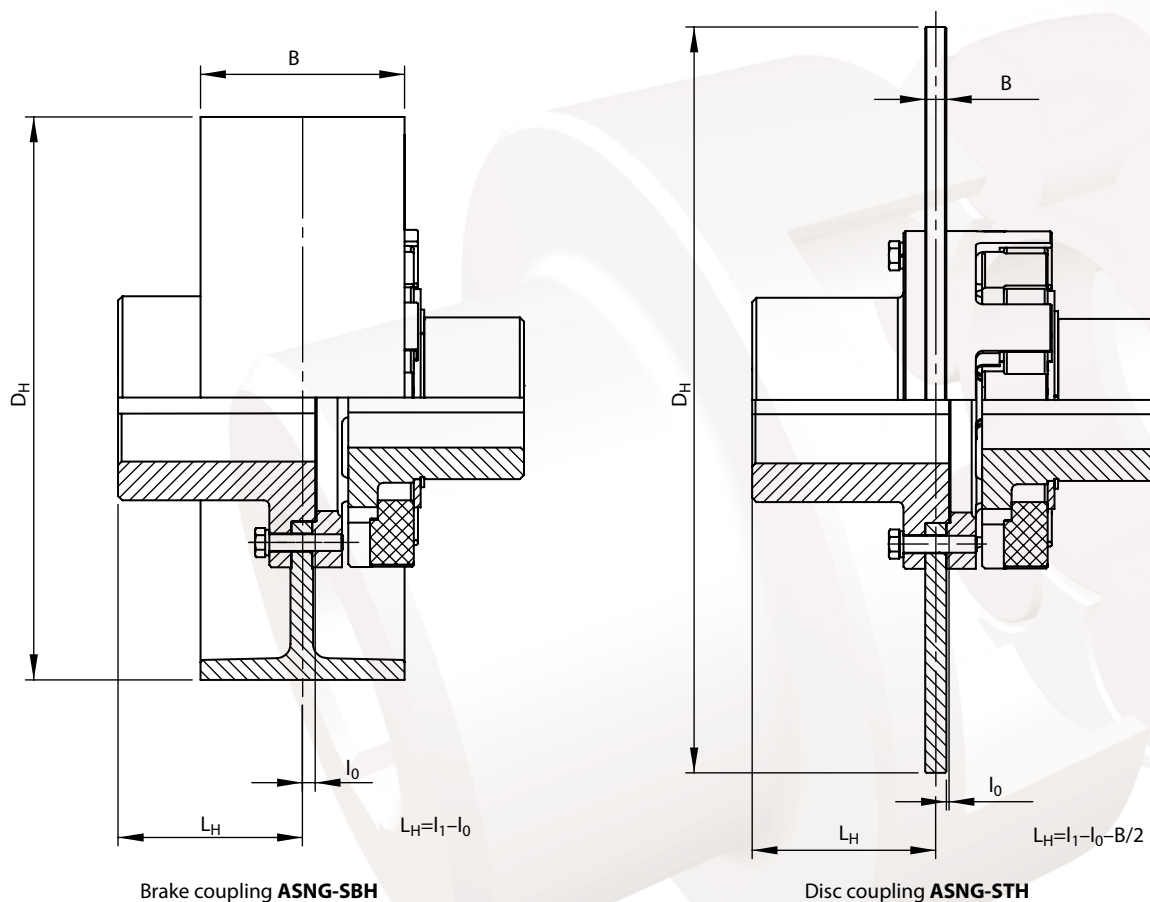

ASG DOUBLE COUPLINGS

With two inserts and the possibility of their replacement without the necessity to draw the pins aside (only series 02 and 03)

DISC – ASG-TH with brake disc

Example of designation of the ASG 02 series type coupling with the nominal torque of $M_n=5000$ Nm, hub holes diameters of $d_1=90$ mm, $d_2=85$ mm, hub holes lengths of $l_1=172$ mm, $l_2=172$ mm, total length $L=430$ mm size of 021: (marking see page A2-1)
5000-90/172-85/172-430- 021ASG Double coupling

with brake disc of diameter $D_H=450$ mm and thickness of 15 mm, Distance of symmetry axis of brake disc $L_H=110$
5000-450x15-110-90/172-85/172-430-021 ASG-TH Disc coupling

- the version „Ex“ – 5000-90/172-85/172-430- 021 ASG-**Ex** Double coupling
 5000-450x15-110-90/172-85/172-430-021 ASG-TH- **Ex** Disc coupling
- Because of used in 03 series material of jaw disc (aluminium) , the couplings of this series should not be used in the areas with the danger of explosion, unless the user admitted them for operation together with the entire device on his own responsibility.
- The replacement of inserts without drawing the pins aside is possible only in series 02 and 03 (in the series 01 it is not possible)